

INES FLAX

YOUR PREMIER OCEANFRONT SPECIALIST
& MOST TRUSTED NAME IN SOUTH FLORIDA REAL ESTATE.

ONE Sotheby's International Realty
119 Washington Ave Suite 33139
Phone: 786.218.7600 -
<https://www.inesflax.com>
Email: InesFlax@aol.com



QUADRO
www.inesflax.com

AIA/AIA

1 BEDROOM
1 BATHROOM

INTERIOR
762,775 SQ. FT.
FLOORS 2-12
SOUTH TOWER

Miami
Design District



NE 39th St.

BISCAYNE BLVD.

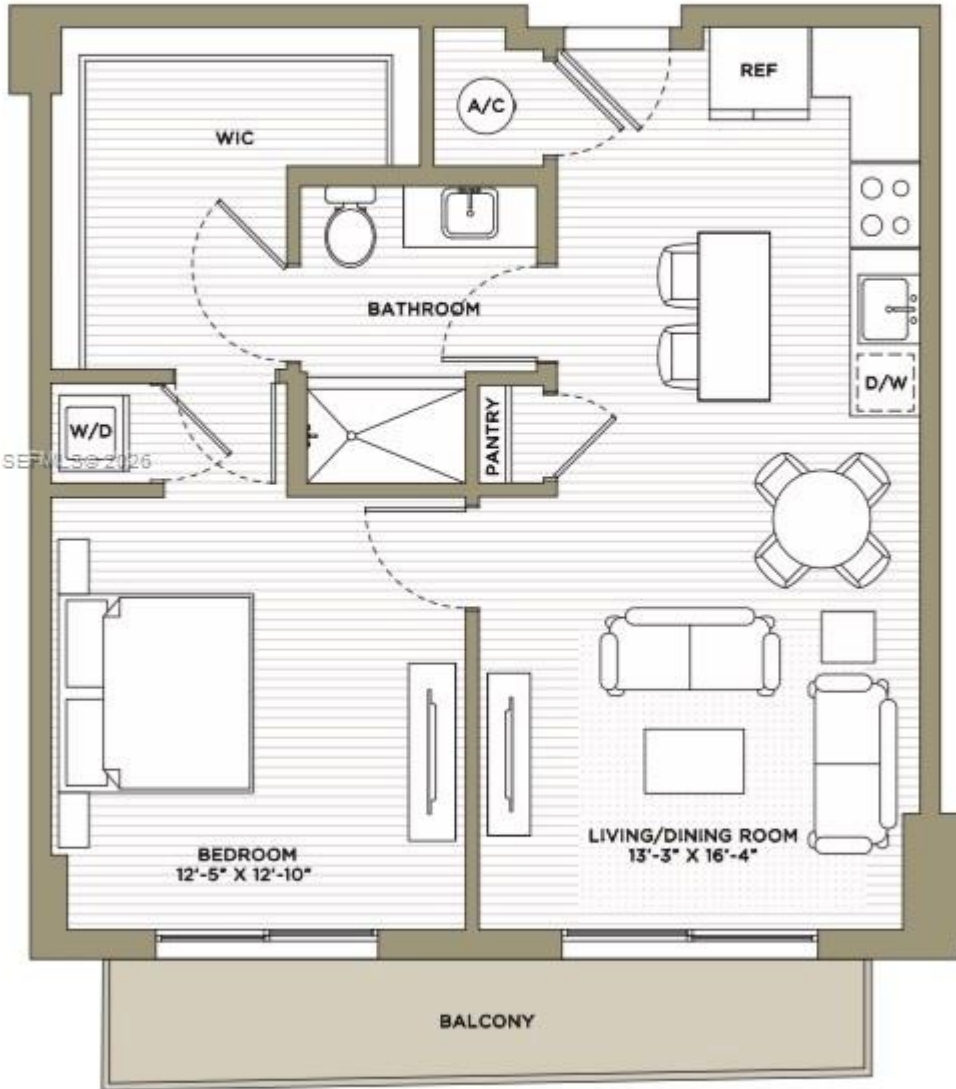

A12008288 SEM 38 2026

Floor plans are artist's rendering. All dimensions are approximate. Actual product and specifications may vary in dimension or detail. Balconies may vary based on layout and location. Not all features are available in every apartment. Prices and availability are subject to change. Please refer to an agent for details.

Price: \$490,000

MLS Number: A12008288

Condo / Town Home

3900 Biscayne Blvd Unit S-906, Miami, Florida 33137 USA

Beds: 1

Baths: 1

Living Area: 699

Unit: S-906

HOA Fees: \$0

Year Built: 2019

Community: Quadro Residences

Subdivision: Quadro Residences

ABOUT THIS PROPERTY

Turnkey and income-ready at Quadro Miami Design District. Unit 906 offers the rare flexibility to live, lease long-term, or operate as a short-term rental with a minimum 3-night stay. This fully furnished residence is thoughtfully designed for immediate occupancy or rental, featuring modern finishes, an open layout, and abundant natural light. Includes 1 assigned parking space. Residents enjoy a full suite of amenities including a resort-style pool, state-of-the-art fitness center, and 24-hour front desk/concierge service. Ideally positioned just minutes from the Miami Design District's renowned dining, luxury shopping, and cultural venues. A seamless opportunity for both end-users and those seeking rental flexibility.

PROPERTY
LOCATION

Image

